

706  
702  
710

# COUPLINGS

## Multi-Beam - Multi-Helix Flexible Beam Coupling

6 Beam *Backlash Free - Set Screw Fixing*

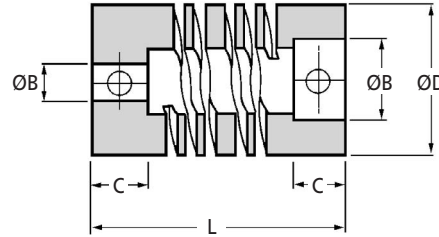
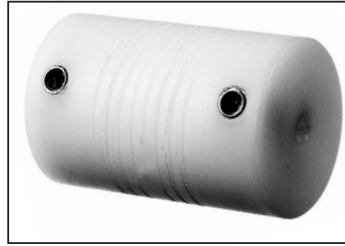

PART NUMBER	Max Bore ØB	Max Bore ØB	ØD	L	C	Set Screw	Ang. Offset	Para Offset	Shock & Reversing Torque Nm	Max Torque Nm
<b>ALUMINIUM</b>										
706.09	3mm	3/16"	3/8"	0.770"	0.208"	M2.5	3°	0.005"	0.25	1.00
706.13	3/16"	1/4"	1/2"	0.900"	0.250"	M3	5°	0.007"	0.50	2.00
706.16	5mm	8mm	5/8"	1.000"	0.250"	M4	5°	0.008"	0.85	3.40
706.19	6mm	10mm	3/4"	1.040"	0.250"	M4	7°	0.010"	1.33	5.30
706.25	8mm	1/2"	1"	1.500"	0.432"	M5	7°	0.015"	2.50	10.00
706.32	10mm	3/4"	1.25"	2.250"	0.625"	M6	7°	0.020"	3.75	15.00
706.38	12mm	7/8"	1.50"	2.630"	0.708"	M6	7°	0.024"	5.50	22.00
706.44	1/2"	1"	1.75"	3.000"	0.787"	M4	7°	0.031"	7.50	30.00
706.51	5/8"	28mm	2.00"	3.750"	0.984"	M8	7°	0.035"	10.00	40.00
706.57	3/4"	32mm	2.25"	5.120"	1.250"	M8	7°	0.037"	13.75	55.00
706.64	25mm	1-1/2"	2.50"	5.900"	1.500"	M8	7°	0.040"	18.75	75.00
<b>STAINLESS</b>										
702.09	3mm	3/16"	3/8"	0.770"	0.208"	M2.5	3°	0.005"	0.38	1.50
702.13	3/16"	1/4"	1/2"	0.900"	0.250"	M3	5°	0.007"	0.75	3.00
702.16	5mm	8mm	5/8"	1.000"	0.250"	M4	5°	0.008"	1.25	5.00
702.19	6mm	10mm	3/4"	1.040"	0.250"	M4	7°	0.010"	2.00	8.00
702.25	8mm	1/2"	1"	1.500"	0.432"	M5	7°	0.015"	4.00	16.00
702.32	10mm	3/4"	1.25"	2.250"	0.625"	M6	7°	0.020"	6.25	25.00
702.38	12mm	7/8"	1.50"	2.630"	0.708"	M6	7°	0.024"	9.00	36.00
702.44	1/2"	1"	1.75"	3.000"	0.787"	M4	7°	0.031"	12.00	48.00
702.51	5/8"	28mm	2.00"	3.750"	0.984"	M8	7°	0.035"	18.25	73.00
702.57	3/4"	32mm	2.25"	5.120"	1.250"	M8	7°	0.037"	25.50	102.00
702.64	25mm	1-1/2"	2.50"	5.900"	1.500"	M8	7°	0.040"	35.00	140.00
<b>ACETAL</b>										
710.13	3/16"	1/4"	1/2"	0.990"	0.250"	M3	5°	0.007"	0.13	0.50
710.16	5mm	8mm	5/8"	1.000"	0.250"	M4	5°	0.008"	0.23	0.90
710.19	6mm	10mm	3/4"	1.040"	0.250"	M4	7°	0.010"	0.33	1.30
710.25	6mm	1/2"	1"	1.500"	0.432"	M5	7°	0.015"	0.63	2.50
710.32	10mm	3/4"	1.25"	2.250"	0.625"	M6	7°	0.020"	1.00	4.00
710.38	12mm	7/8"	1.50"	2.630"	0.708"	M6	7°	0.024"	1.50	6.00

### Material

706: Aluminium L168 (HE15TF) 702: Stainless Steel 303 S3U 710: Acetal

### Other Info.

Finished Bore sizes to +0.03/0.00.

Max. torque rating for momentary loads only. If chamber modified torque figures will change. The chamber diameter normally corresponds to the maximum permissible end bore. Boring out service available at extra cost. Add bore size required to end of part number eg. 706.39-2/3 (bored Ø2mm & Ø3mm)



1-888-260-7466



516-867-5656

# COUPLINGS

## Multi-Beam - Multi-Helix Flexible Beam Coupling

6 Beam *Backlash Free - Clamp Fixing*

707  
703  
711

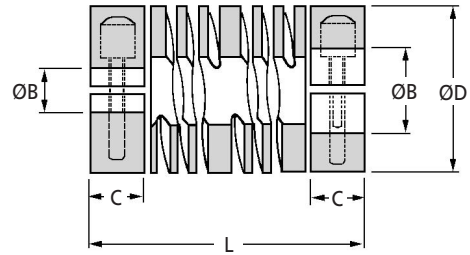
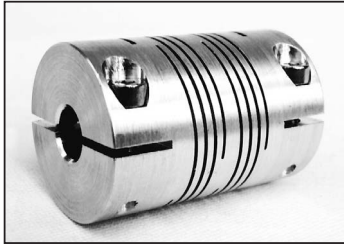

PART NUMBER	Max Bore ØB	Max Bore ØB	ØD	L	C	Set Screw	Ang. Offset	Para Offset	Shock & Reversing Torque Nm	Max Torque Nm
<b>ALUMINIUM</b>										
707.09	3mm	3/16"	3/8"	0.770"	0.208"	M1.6	3°	0.005"	0.25	1.00
707.13	3/16"	1/4"	1/2"	0.900"	0.250"	M2	5°	0.007"	0.50	2.00
707.16	5mm	8mm	5/8"	1.000"	0.250"	M2.5	5°	0.008"	0.85	3.40
707.19	6mm	10mm	3/4"	1.040"	0.250"	M2.5	7°	0.010"	1.33	5.30
707.25	8mm	1/2"	1"	1.500"	0.432"	M3	7°	0.015"	2.50	10.00
707.32	10mm	16mm	1.25"	2.250"	0.625"	M4	7°	0.020"	3.75	15.00
707.38	12mm	3/4"	1.50"	2.630"	0.708"	M5	7°	0.024"	5.50	22.00
707.44	1/2"	7/8"	1.75"	3.000"	0.787"	M5	7°	0.031"	7.50	30.00
707.51	5/8"	26mm	2.00"	3.750"	0.984"	M6	7°	0.035"	10.00	40.00
707.57	3/4"	1-3/16"	2.25"	5.120"	1.250"	M6	7°	0.037"	13.75	55.00
707.64	25mm	36mm	2.50"	5.900"	1.500"	M8	7°	0.040"	18.75	75.00
<b>STAINLESS</b>										
703.09	3mm	3/16"	3/8"	0.770"	0.208"	M1.6	3°	0.005"	0.38	1.50
703.13	3/16"	1/4"	1/2"	0.900"	0.250"	M2	5°	0.007"	0.75	3.00
703.16	5mm	8mm	5/8"	1.000"	0.250"	M2.5	5°	0.008"	1.25	5.00
703.19	6mm	10mm	3/4"	1.040"	0.250"	M2.5	7°	0.010"	2.00	8.00
703.25	8mm	1/2"	1"	1.500"	0.432"	M3	7°	0.015"	4.00	16.00
703.32	10mm	16mm	1.25"	2.250"	0.625"	M4	7°	0.020"	6.25	25.00
703.38	12mm	3/4"	1.50"	2.630"	0.708"	M5	7°	0.024"	9.00	36.00
703.44	1/2"	7/8"	1.75"	3.000"	0.787"	M5	7°	0.031"	12.00	48.00
703.51	5/8"	26mm	2.00"	3.750"	0.984"	M6	7°	0.035"	18.25	73.00
703.57	3/4"	1-3/16"	2.25"	5.120"	1.250"	M6	7°	0.037"	25.50	102.00
703.64	25mm	36mm	2.50"	5.900"	1.500"	M8	7°	0.040"	35.00	140.00
<b>ACETAL</b>										
711.13	3/16"	1/4"	1/2"	0.990"	0.250"	M2	5°	0.007"	0.13	0.50
711.16	5mm	8mm	5/8"	1.000"	0.250"	M2.5	5°	0.008"	0.23	0.90
711.19	6mm	10mm	3/4"	1.040"	0.250"	M2.5	7°	0.010"	0.33	1.30
711.25	6mm	1/2"	1"	1.500"	0.432"	M3	7°	0.015"	0.63	2.50
711.32	10mm	16mm	1.25"	2.250"	0.625"	M4	7°	0.020"	1.00	4.00
711.38	12mm	3/4"	1.50"	2.630"	0.708"	M5	7°	0.024"	1.50	6.00

### Material

707: Aluminium L168 (HE15TF) 703: Stainless Steel 303 S3U 711: Acetal

### Other Info.

Finished Bore sizes to +0.03/0.00.

Maximum torque rating for momentary loads only. If chamber modified torque figures will change. The chamber diameter normally corresponds to the maximum permissible end bore. Boring out service available at extra cost. Add bore size required to end of part number eg. **707.09/2.5** (bored Ø3mm & Ø2.5mm)



[sales@rinomechanical.com](mailto:sales@rinomechanical.com)



[www.rinomechanical.com](http://www.rinomechanical.com)



724  
720  
728

# COUPLINGS

## Multi-Beam - Multi-Helix Flexible Beam Coupling

3 Beam *Backlash Free - Set Screw Fixing*



3 Beam Set Screw Fixing

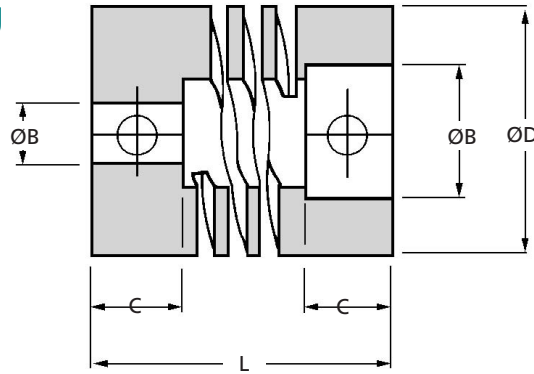

PART NUMBER	Min. Bore ØB	Max. Bore ØB	ØD	L	C	Set Screw	Angular Offset	Parallel Offset	Shock & Reversing Torque Nm	Max Torque Nm
<b>ALUMINIUM</b>										
724.06	2mm	3mm	1/4"	1/2"	1.800"	M2	3°	0.003"	0.10	0.40
724.09	3mm	1/8"	3/8"	0.560"	4.5mm	M2.5	3°	0.004"	0.10	0.40
724.13	4mm	5mm	1/2"	0.750"	6.0mm	M3	5°	0.005"	0.23	0.90
724.16	5mm	1/4"	5/8"	0.800"	6.5mm	M3	5°	0.005"	0.38	1.50
724.19	6mm	5/16"	3/4"	0.900"	6.5mm	M4	5°	0.005"	0.63	2.50
724.25	8mm	7/16"	1"	1.250"	9.0mm	M4	5°	0.005"	1.00	4.00
724.32	10mm	14mm	1-1/4"	1.750"	12.0mm	M6	5°	0.005"	1.50	6.00
<b>STAINLESS</b>										
720.06	2mm	3mm	1/4"	1/2"	1.800"	M2	3°	0.003"	0.11	0.50
720.09	3mm	1/8"	3/8"	0.560"	4.5mm	M2.5	3°	0.004"	0.13	0.50
720.13	4mm	5mm	1/2"	0.750"	6.0mm	M3	5°	0.005"	0.25	1.00
720.16	5mm	1/4"	5/8"	0.800"	6.5mm	M3	5°	0.005"	0.45	1.80
720.19	6mm	5/16"	3/4"	0.900"	6.5mm	M4	5°	0.005"	0.68	2.70
720.25	8mm	7/16"	1"	1.250"	9.0mm	M4	5°	0.005"	1.50	6.00
720.32	10mm	14mm	1-1/4"	1.750"	12.0mm	M6	5°	0.005"	2.50	10.00
<b>ACETAL</b>										
728.13	4mm	5mm	1/2"	0.750"	6.0mm	M3	5°	0.005"	0.06	0.24
728.16	5mm	1/4"	5/8"	0.800"	6.5mm	M4	5°	0.005"	0.09	0.35
728.19	6mm	5/16"	3/4"	0.900"	6.5mm	M4	5°	0.005"	0.16	0.64
728.25	8mm	7/16"	1"	1.250"	9.0mm	M5	5°	0.005"	0.35	1.40
728.32	10mm	14mm	1-1/4"	1.750"	12.0mm	M6	5°	0.005"	0.63	2.50

### Material

724: Aluminium L168 (HE15TF) 720: Stainless Steel 303 S3U 728: Acetal

### Other Info.

Finished Bore sizes to +0.03/0.00. Max. torque rating for momentary loads only. If chamber modified torque figures will change.

Boring out service available at extra cost. Add bore size required to end of part number eg. 724.13-4/4 (bored Ø4mm & Ø4mm)



# COUPLINGS

## Multi-Beam - Multi-Helix Flexible Beam Coupling

3 Beam *Backlash Free - Clamp Fixing*

725  
721  
729

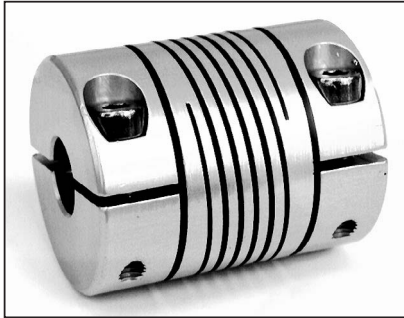

3 Beam Clamp Fixing

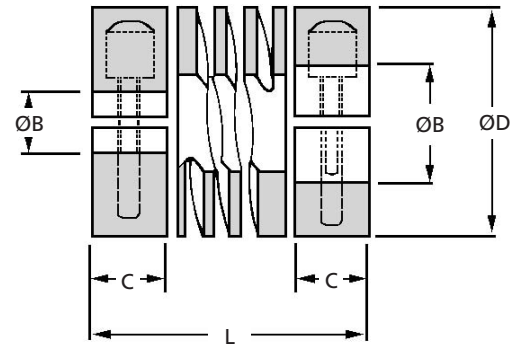

PART NUMBER	Min. Bore ØB	Max. Bore ØB	ØD	L	C	Clamp Screw	Angular Offset	Parallel Offset	Shock & Reversing Torque Nm	Max Torque Nm
<b>ALUMINIUM</b>										
725.09	3mm	1/8"	3/8"	0.560"	4.5mm	M1.6	3°	0.004"	0.10	0.40
725.13	4mm	5mm	1/2"	0.750"	6.0mm	M2	5°	0.005"	0.23	0.90
725.16	5mm	1/4"	5/8"	0.800"	6.5mm	M2.5	5°	0.005"	0.38	1.50
725.19	6mm	5/16"	3/4"	0.900"	6.5mm	M2.5	5°	0.005"	0.63	2.50
725.25	8mm	7/16"	1"	1.250"	9.0mm	M3	5°	0.005"	1.00	4.00
725.32	10mm	14mm	1-1/4"	1.750"	12.0mm	M4	5°	0.005"	1.50	6.00
<b>STAINLESS</b>										
721.09	3mm	1/8"	3/8"	0.560"	4.5mm	M1.6	3°	0.004"	0.13	0.50
721.13	4mm	5mm	1/2"	0.750"	6.0mm	M2	5°	0.005"	0.25	1.00
721.16	5mm	1/4"	5/8"	0.800"	6.5mm	M2.5	5°	0.005"	0.45	1.80
721.19	6mm	5/16"	3/4"	0.900"	6.5mm	M2.5	5°	0.005"	0.68	2.70
721.25	8mm	7/16"	1"	1.250"	9.0mm	M3	5°	0.005"	1.50	6.00
721.32	10mm	14mm	1-1/4"	1.750"	12.0mm	M4	5°	0.005"	2.50	10.00
<b>ACETAL</b>										
729.13	4mm	5mm	1/2"	0.750"	6.0mm	M2	5°	0.005"	0.06	0.24
729.16	5mm	1/4"	5/8"	0.800"	6.5mm	M2.5	5°	0.005"	0.09	0.35
729.19	6mm	5/16"	3/4"	0.900"	6.5mm	M2.5	5°	0.005"	0.16	0.64
729.25	8mm	7/16"	1"	1.250"	9.0mm	M3	5°	0.005"	0.35	1.40
729.32	10mm	14mm	1-1/4"	1.750"	12.0mm	M4	5°	0.005"	0.63	2.50

### Material

725: Aluminium L168 (HE15TF) 721: Stainless Steel 303 S3U 729: Acetal

### Other Info.

Finished Bore sizes to +0.03/0.00. Max. torque rating for momentary loads only.

If chamber modified torque figures will change.

Boring out service available at extra cost. Add bore size required to end of part number eg. 725.13-4/4 (bored Ø4mm & Ø4mm)



sales@rinomechanical.com



www.rinomechanical.com

